

ESBE SERIES CUA110



Series CUA110

CE

LVD 2006/95/EC
EMC 2004/108/EC
RoHS 2002/95/EEC

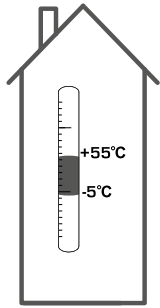

1

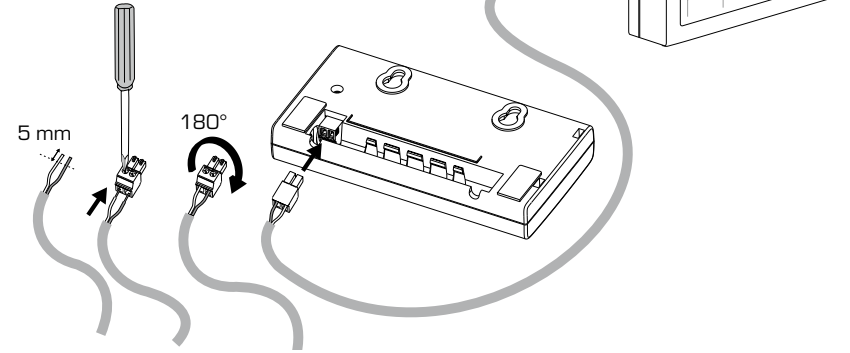
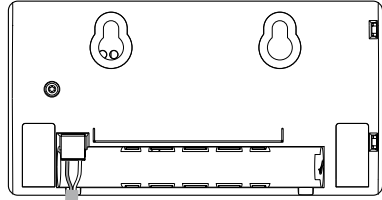

2



1

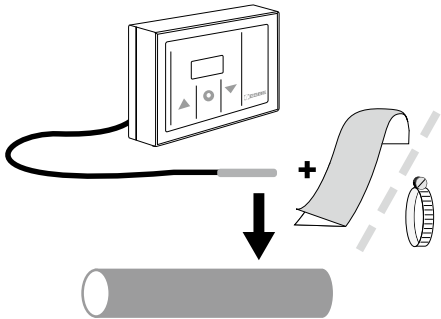

2

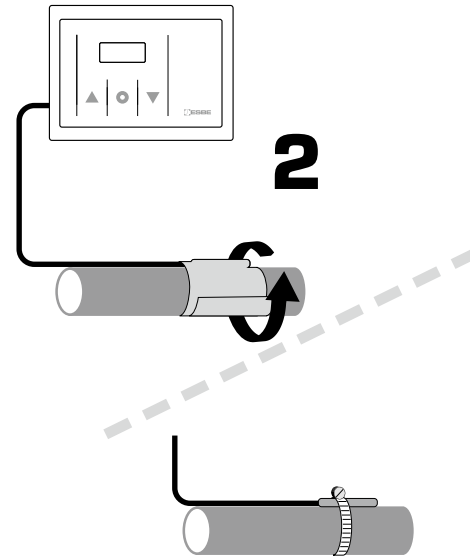

3

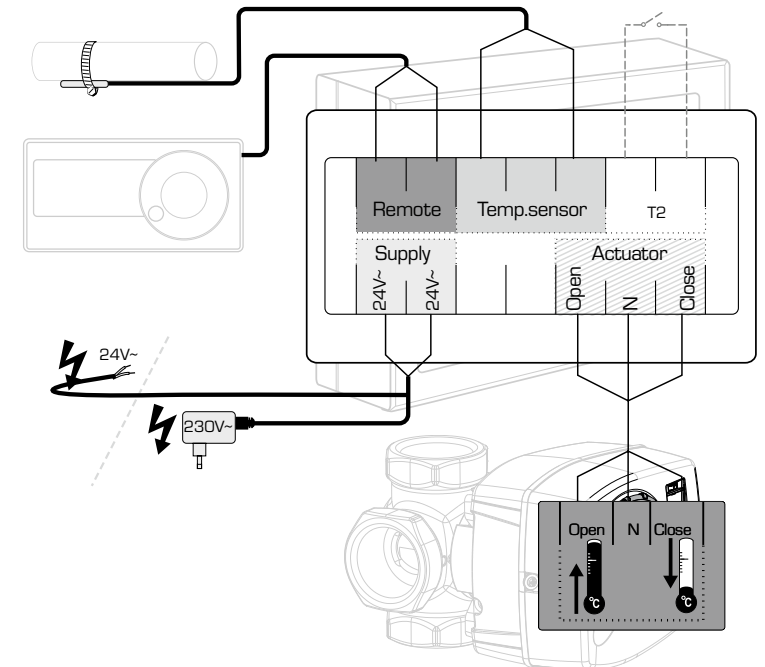

4

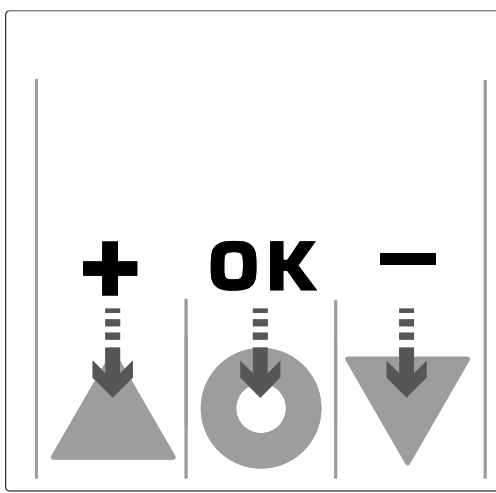

www.esbe.se

Mtrl.nr. 9814 03 93 • Ritn.nr. 9213 utg. B • Rev. 1012

5

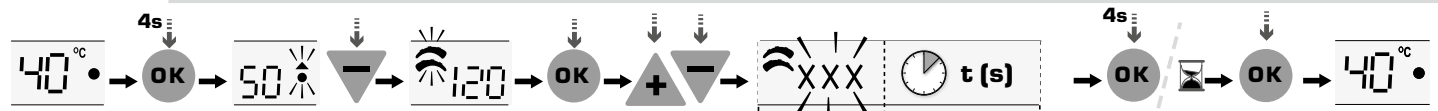
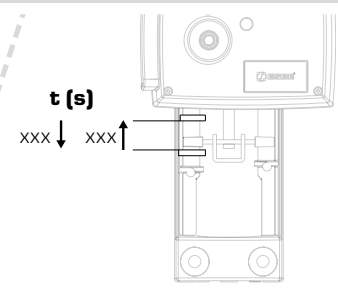
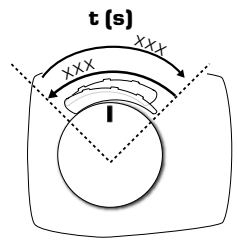
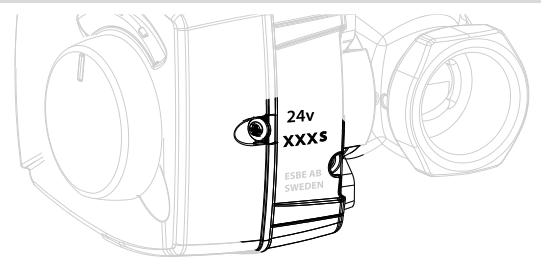

XXX	t (s)
015	< 25
030	26 - 45
060	46 - 90
120	91 - 180
240	181 - 360
480	> 360



SERIES CUA110



NO.1 IN HYDRONIC SYSTEM CONTROL

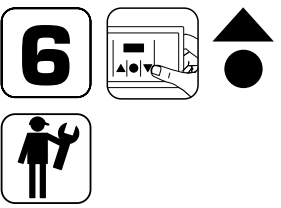

▲ = MAX °C

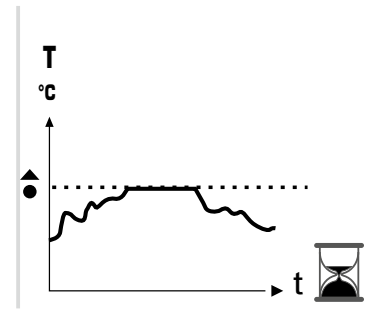
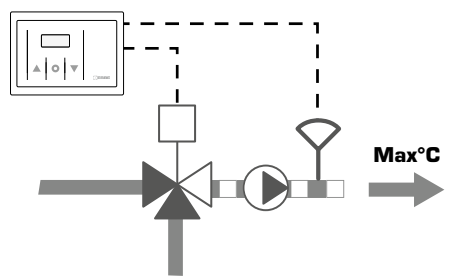

	50 °C
	~40 - 50 °C
	~60 - 80 °C

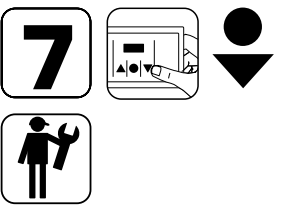
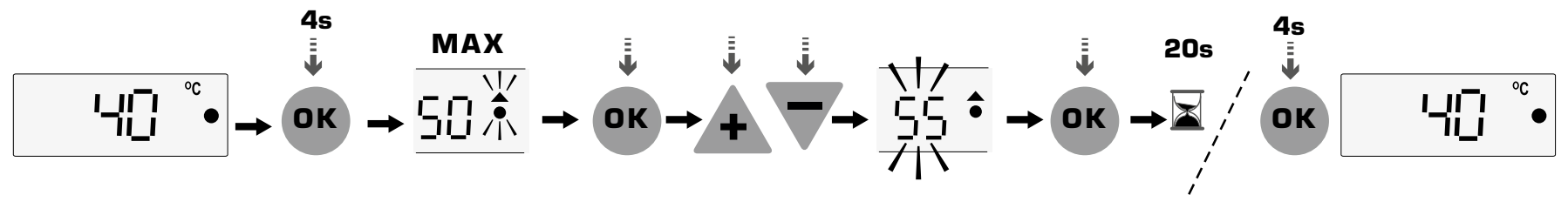

▼ = MIN °C

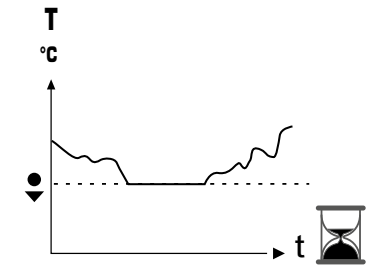
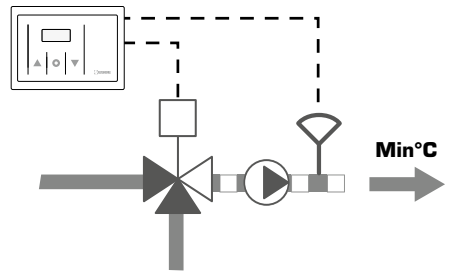

	5 °C
	~5 - 25 °C
	~5 - 25 °C

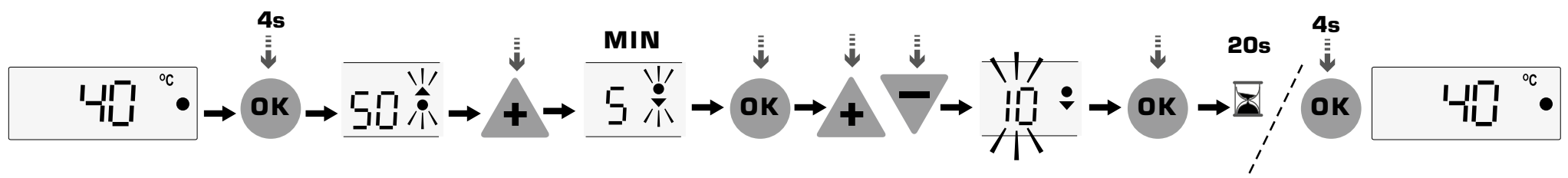

8



i

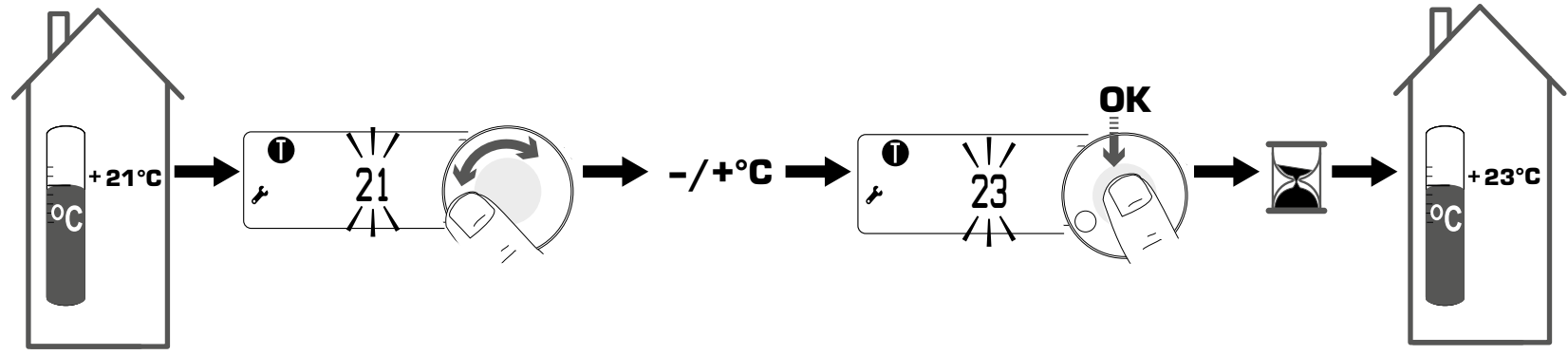
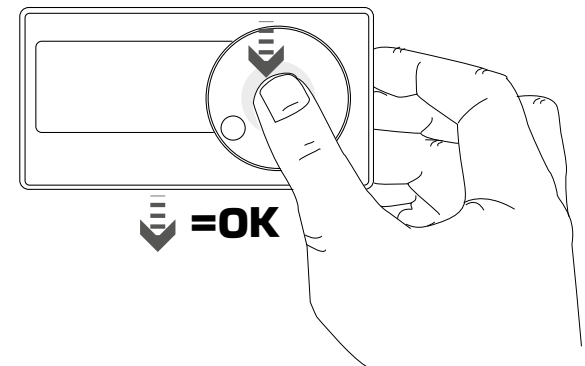
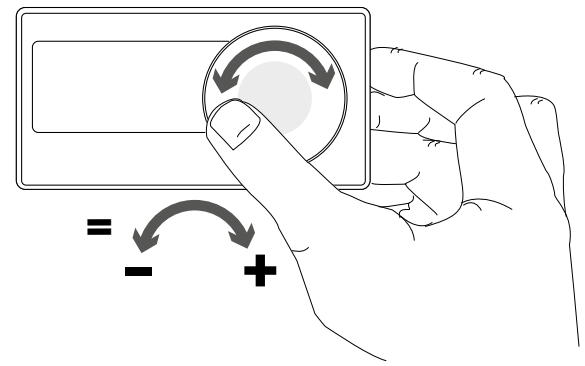

i **MAX**

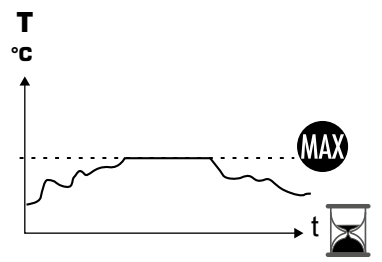
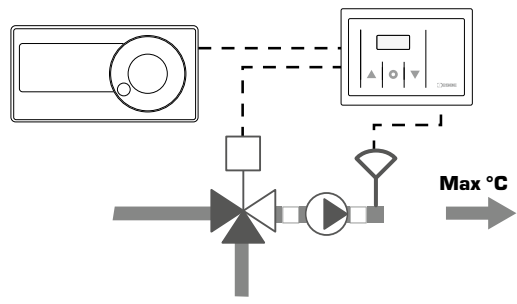

	50 °C
	~40 - 50 °C
	~60 - 80 °C
	60 °C

i **MAX** **MIN** **C**

4s

21

OK **50** **MAX**

OK **55** **MAX**

-/+°C

OK

i **MIN**

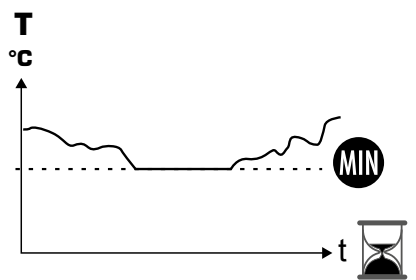
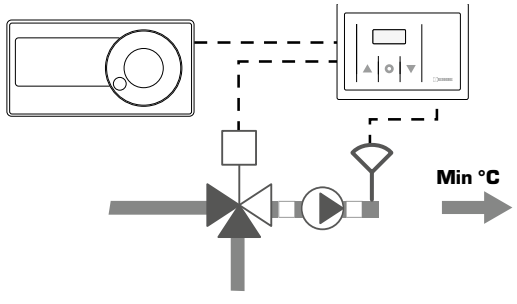

	5 °C
	~5 - 25 °C
	~5 - 25 °C
	~5 - 25 °C

i **MAX** **MIN** **C**

4s

21

OK **5** **MIN**

OK **10** **MIN**

-/+°C

OK

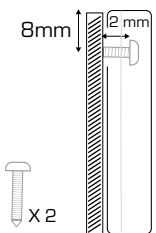
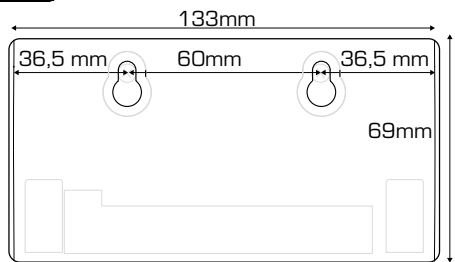
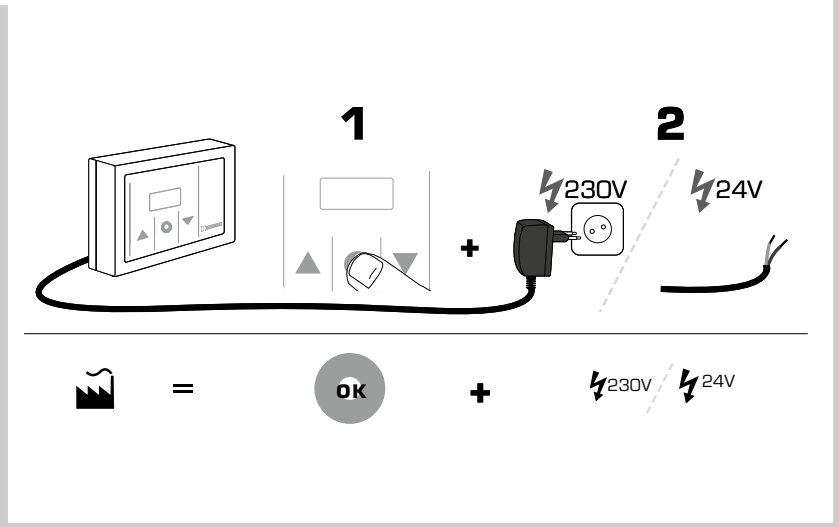
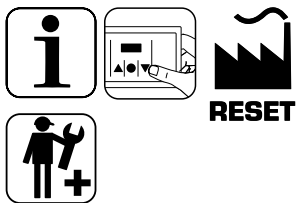



i

C-0

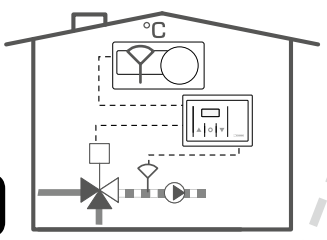

C-1

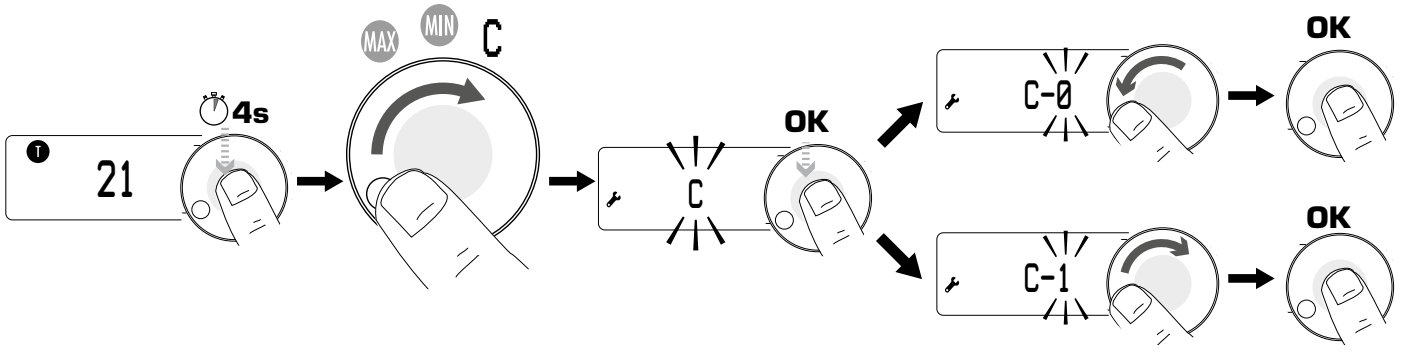
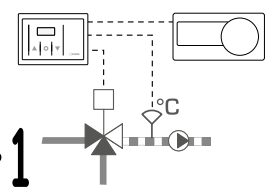

i  **T2**

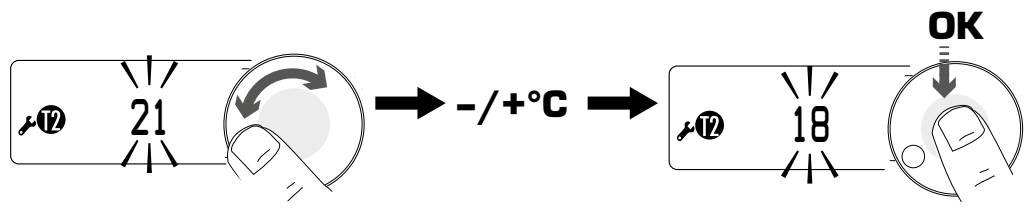
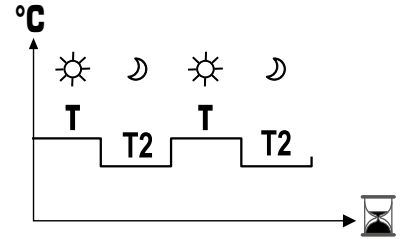
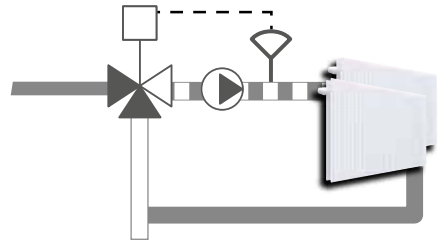
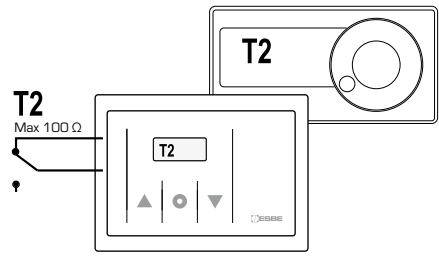

T

